



Child Safe - Yard Duty & Supervision Policy



Help for non-English speakers.

If you need help to understand the information in this policy, please contact Sherbourne PS on 9434 7142 so that an interpreter can be booked.

PURPOSE

To ensure school staff understand their supervision and yard duty responsibilities.

SCOPE

This policy applies to all teaching and non-teaching staff at Sherbourne PS, including education support staff, casual relief teachers and visiting teachers.

POLICY

Appropriate supervision is an important strategy to monitor student behaviour and enables staff to identify and respond to possible risks at school as they arise. It also plays a vital role in helping schools to discharge their duty of care to students.

The Principal is responsible for ensuring that there is a well organised and responsive system of supervision and yard duty in place during school hours, before and after school, and on school excursions and camps and other school activities.

School staff are responsible for following reasonable and lawful instructions from the Principal, including instructions to provide supervision to students at specific dates, times and places. Supervision should be undertaken in a way that identifies and mitigates risks to child safety.

Before and after school

Sherbourne PS grounds are supervised by school staff from 8.40am until 3.45pm. Outside of these hours, school staff will not be available to supervise students.

Parents and carers will be advised through regular reminders in our newsletter that they should not allow their children to attend Sherbourne PS outside of these hours. Families will be encouraged to contact the school office for more information about the before and after school care facilities available to our school community.

If a student arrives at school before supervision commences at the beginning of the day, the Principal or nominee staff member will, as soon as practicable, follow up with the parent/carer to:

- advise of the supervision arrangements before school
- request that the parent/carer make alternate arrangements.

If a student is not collected before supervision finishes at the end of the day, the Principal or nominee staff member will consider whether it is appropriate to:

- attempt to contact the parents/carers.
- attempt to contact the emergency contacts.
- place the student in an out of school hours care program (if available and the parent consents)
- contact Victoria Police and/or Child Protection to arrange for the supervision, care and protection of the student.

Yard duty

All staff at Sherbourne PS are expected to assist with yard duty supervision and will be included in the weekly roster.

The Principal is responsible for preparing and communicating the yard duty roster on a regular basis. At Sherbourne PS, school staff will be designated a specific yard duty area to supervise

Yard duty zones

The designated yard duty areas for our school for 2024 are as follows:

Zone	Area
Zone 1	Basketball courts, Oval.
Zone 2	Big Adventure playground, rock climbing wall.

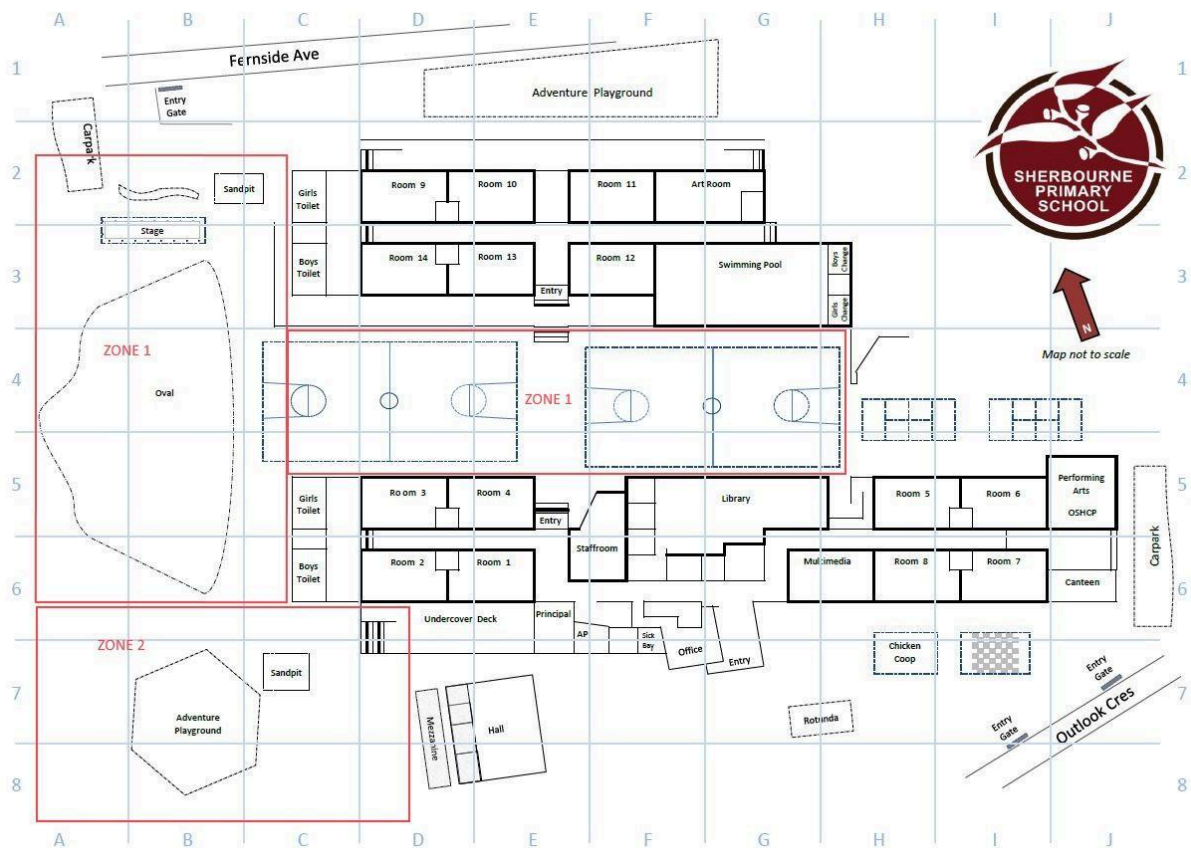

Yard duty equipment

School staff must:

- wear a provided safety/hi-vis vest whilst on yard duty. Safety/hi-vis vests will be stored in the First Aid tub with the bags.
- always carry the yard duty first aid bag during supervision. The yard duty first aid bag will be stored in the office and moved outside to the changeover area outside the staffroom at the bottom of the stairs and the start of cover way.
- Be familiar with the yard duty information pack containing student health and safety information stored in the Yard Duty bag.
- Carry a mobile phone.

Yard duty equipment must be returned after the period of supervision or handed to the relieving staff member.

Yard duty responsibilities

Staff who are rostered for yard duty must remain in the designated area until they are replaced by a relieving staff member.

During yard duty, supervising school staff must:

- methodically move around the designated zone ensuring active supervision of all students
- where safe to do so, approach any unknown visitor who is observed on school grounds without a clear legitimate purpose, and ensure they have a visitor pass and have signed in (excluding drop off and collection periods).
- be alert and vigilant.
- intervene immediately if potentially dangerous or inappropriate behaviour is observed in the yard.
- enforce behavioural standards and implement appropriate consequences for breaches of safety rules, in accordance with any relevant disciplinary measures set out in the school's [Student Engagement policy](#).
- ensure that students who require first aid assistance receive it as soon as practicable.
- log any incidents or near misses on Compass including an alert to classroom teacher and Principal when appropriate in severity.

If being relieved of their yard duty shift by another staff member, the staff member must ensure that a brief, but adequate verbal 'handover' is given to the relieving staff member in relation to any issues which may have arisen during the first shift.

Staff members who cannot do a rostered yard duty shift must contact the Principal with as much notice as possible prior to the relevant shift to ensure that alternative arrangements are made.

If the supervising staff member needs to leave yard duty during the allocated time, they should contact the staffroom or Principal and should not leave the designated area until the relieving staff member has arrived in the designated area.

If the relieving staff member does not arrive for yard duty, the staff member currently on duty should send a message to the office/call Principal and not leave the designated area until a relieving staff member has arrived.

In the event of staff absence, the staff member in charge of CRT management will be responsible for organising the CRT replacement for that staff member (including yard duties) and communicating this on the staff whiteboard.

Students will be encouraged to speak to the supervising yard duty staff member if they require assistance during recess or lunchtime.

Classroom

The classroom teacher is responsible for the supervision of all students in their care during class.

If a teacher needs to leave the classroom unattended at any time during a lesson, they should first contact the adjacent classroom or front office or Principal for assistance. The teacher should then wait until a replacement staff member has arrived at the classroom before leaving.

A staff member must accompany any student who has asked to leave the classroom (e.g. for behavioural reasons).

School activities, camps and excursions

The Principal and leadership team are responsible for ensuring that students are appropriately supervised during all school activities, camps and excursions, including when external providers are engaged to conduct part or all of the activity. Appropriate supervision will be planned for school activities, camps and excursions on an individual basis, depending on the activities to be undertaken and the level of potential risk involved, and will follow the supervision requirements in the Department of Education and Training [Excursions Policy](#).

Digital devices and virtual classroom

Sherbourne PS follows the Department's [Cybersafety and Responsible Use of Technologies Policy](#) with respect to supervision of students using digital devices.

Sherbourne PS will also ensure appropriate supervision of students participating in remote and flexible learning environments while on school site. In these cases, students will be supervised in their classroom or other supervised area.

While parents are responsible for the appropriate supervision of students accessing virtual classrooms from home:

- student attendance will be monitored through roll marking in Compass. This will be completed by the classroom teacher in the morning and afternoon.
- any wellbeing or safety concerns for the student will be managed in accordance with our usual processes – refer to our Student Wellbeing and Engagement Policy and our Child Safety Responding and Reporting Policy and Procedures for further information.

Students requiring additional supervision support

Sometimes students will require additional supervision, such as students with disability or other additional needs. In these cases, the Principal or delegate will ensure arrangements are made to roster additional staff as required. This may include on yard duty, in the classroom or during school activities.

Supervision of student in emergency operating environments

In emergency circumstances our school will follow our Emergency Management Plan, including with respect to supervision.

In the event of any mandatory period of remote or flexible learning our School will follow the operations guidance issued by the Department.

Other areas requiring supervision

At Sherbourne Primary School students travel to use the bathroom, take messages, perform monitor duties in groups of 3.

Classes moving from one area of the school to another must move in an ordered fashion and at all times be supervised by a staff member, e.g. travelling to a specialist class.

Students may not enter a classroom or building at lunch or recess without the presence of a supervising adult.

COMMUNICATION

This policy will be communicated to our school community in the following ways:

- Included in staff induction processes.
- [Published on school website.](#)
- Discussed at staff briefings or meetings, as required.
- Made available in hard copy from School administration upon request.
- Information for parents and students on supervision before and after school is available on our school website and on the Compass portal.

FURTHER INFORMATION AND RESOURCES

- the Department's Policy and Advisory Library (PAL):
 - [Child Safe Standards](#)
 - [Cybersafety and Responsible Use of Technologies](#)
 - [Duty of Care](#)
 - [Excursions](#)
 - [School Community Work](#)
 - [Supervision of Students](#)
 - [Visitors in Schools](#)

POLICY REVIEW AND APPROVAL

Policy last reviewed	May 2026
Approved by	Mental Health & Wellbeing Leader & School Council
Next scheduled review date	May 2028

This policy will also be updated if significant changes are made to school grounds that require a revision of Sherbourne PS yard duty and supervision arrangements.



Child Safe - Yard Duty & Supervision Policy